

PHILIPS

POWER ADAPTER
 MODEL: DSA-9W-A F xy(DVE) G-F-P101 X-050150 Z(GFT)
 INPUT: 100-240V~50/60Hz 0.3A
 OUTPUT: 5V~1.5A

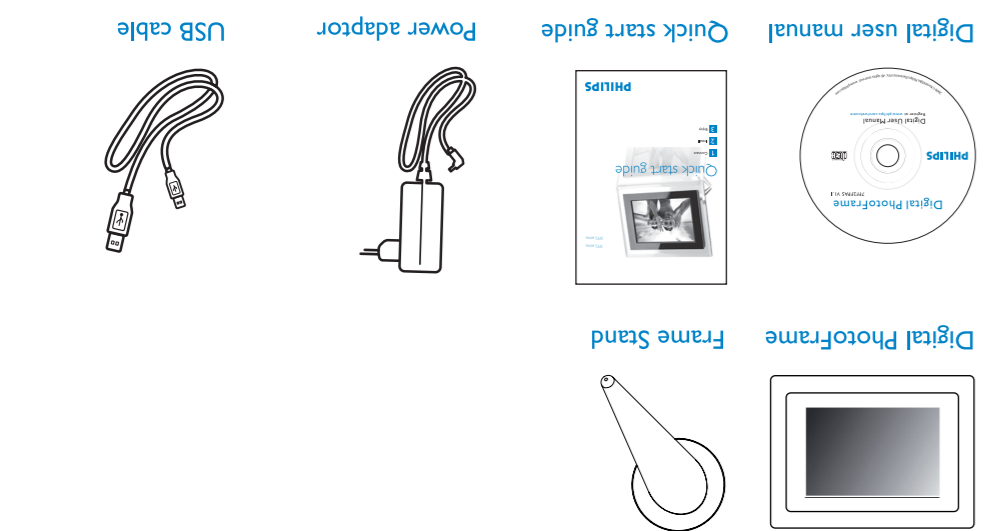
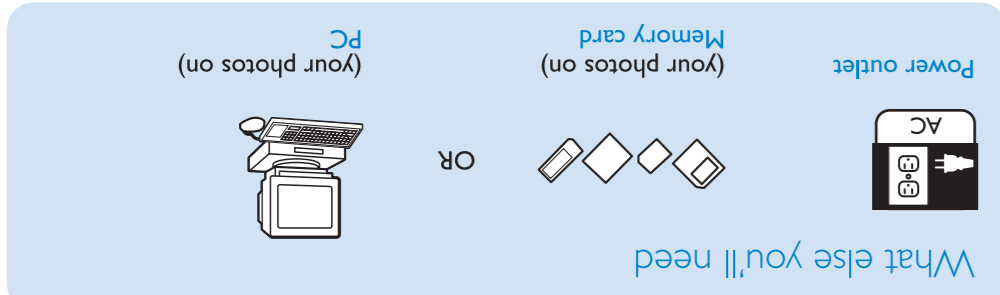

What's in the box

PhotoFrame

7FF2FFAS



- 1 Connect
- 2 Setup
- 3 Enjoy

2008 © Koninklijke Philips Electronics N.V.
 All rights reserved.
 Specifications are subject to change without notice.
 Trademarks are the property of Koninklijke Philips Electronics N.V. or their respective owners.



Welcome to Philips!
 Register your product and get support at
 Online help: www.philips.com/welcome

- ### Frequently Asked Questions
- Q Is the LCD screen touch-enabled?
 A The LCD screen is not touch-enabled. Use the keys in the back of the frame to control digital photo display.
 - Q After copying photos, how can I check to see if the photos are already stored inside?
 A The photos are copied after the screen confirms with "finished".
 - Q Can I switch between different photo slideshows by using different memory cards?
 A Yes, photo frame will show the slideshow photos in the card currently connected.
 - Q Can I use photo frame to delete photos on memory card?
 A Yes, it supports operations to delete photos on external devices.
 - Q Can I print photos from Digital photo display?
 A No, it does not support direct photo printing.

Set Auto on/off timer functions

Photo display can be enabled to turn on and off at pre-set times daily.
CAUTION Auto on/off settings are erased if the photo frame is unplugged.

- Press **Enter** key to return main menu and exit SETTINGS.
- Press **Left** key to set auto on or auto off time.
- Press **Right** key to set **On** or **Off**, and then press **Enter** key to set **On** or **Off**.
- Press **Left** key to select **Set On/Off** to switch. Press **Enter**.
- Press **Left** key to select **Auto On/Off**. Press **Enter** key to photo frame is unplugged.

1 Connect

A Attach the Stand

- Place the head of the stand in the socket.
- Rotate counterclockwise until the stand clicks into place.

CAUTION To help prevent damage, do not hold the frame by the stand. Grasp the frame firmly using two hands.

B Connect the power adaptor

- Connect the supplied power adaptor to the photo frame and then plug it to a power outlet.

2 Setup

Locate the control keys

Control keys on the back of the frame and corresponding function icons on the front of the LCD display enable you to maneuver through the menus and customize your settings.

Back/Left
 Next/Right
 Slide Mode
 Show/Hide menu
 Return

Up
 Down
 Browse Mode
 Photo menu
 Clock

Enter
 Main Menu
 Thumbnail Mode
 Add/Cancel photo

A Turn on the PhotoFrame

Push the power button on the back of the frame for approximately **2 seconds**.

- The power LED will glow blue and the Startup screen will appear.

B Choose language

Menu buttons are on the back of the photo frame. Icons indicate location of buttons found on the back of the panel.

- Press **Left** key to select **Language**. Press **Enter** key to enter.
- Press **Left** key to select **Language** settings. Press **Enter** key to enter.
- Press **Left** key to select. Press **Enter** key to set your language.
- Use **Left** key to return and exit SETTINGS.

3 Enjoy

View pre-stored photos

There are 3 view modes to choose from:
Browse Mode: manual viewing of photos one by one.
Thumbnail Mode: list of all photos.
Slide Mode: automatic, rotating display of photos.

- Press **Left** key to select **Internal Memory**. Press **Enter** key to enter.
- Press **Left** key to select **Album**. Press **Enter** key to enter **Thumbnail Mode**, and press **Right** key to enter **Slide Mode**, press **Left** key to enter **Browse Mode**.
- You may also enter **Slide Mode** directly by pressing **Right** key from the main menu.

View photos from your memory card

Use left slot for Secure Digital(MMC)/xDiMemory Stick card. Slide card with end first and face up.
 Use right slot for Compact Flash card. Slide card with end first and face down.

- Press **Left** key to select **Internal Memory**. Press **Enter** key to enter.
- Press **Left** key to select inserted memory card. Press **Enter** key to enter.
- Press **Left** key to select **Album**. Press **Enter** key to enter **Thumbnail Mode**. After a few seconds, photos in your memory card will appear.
- Then press **Right** key to enter **Slide Mode**, press **Left** key to enter **Browse Mode**.

If the memory card is inserted before the power is ON, Slideshow will automatically start.

Copy or copy all photos from your memory card

Copying photo mode

- In the thumbnail mode, use **Left** key to select photo.
- Press **Right** key to add/cancel selected photos. After selecting, press **Left** key to show photo menu.
- Press **Left** key to select **Copy to** or **Copy all** to your memory card.
- Press **Enter** key to copy.

Photo frame will keep a resized copy of the photo until its internal memory is full (message shown).

Delete or Delete all photos from your memory card

Deleting photo mode

- In the thumbnail mode, use **Left** key to select photo.
- Press **Right** key to add/cancel selected photos. After selecting, press **Left** key to show photo menu.
- Press **Left** key to select **Delete** or **Delete all** from your memory card.
- Press **Enter** key to delete.

Copy/ Delete photos by connecting to your computer

You may copy, delete and move photos by connecting the photo framewith the computer through the provided USB cable.

- Turn on the power of the photo frame, and then plug the smaller end of the USB cable into the USB port on the underside of the photo frame.
- Plug the other end of the USB cable into the USB port of the computer.

Set Time and Date functions

Set Time functions

- Press **Left** key to select **Time and Date**. Press **Enter** key to enter.
- Press **Left** key to select **Time and Date**. Press **Enter** key to enter.
- Press **Left** key to select **Time** to setup. Press **Enter** key to set hour and minutes.
- Press **Left** key to return main menu and exit SETTINGS.

CAUTION Time and date settings are erased if the photo frame is unplugged.

Set Date functions

- Press **Left** key to select **Time and Date**. Press **Enter** key to enter.
- Press **Left** key to select **Time and Date**. Press **Enter** key to enter.
- Press **Left** key to select **Date** to setup. Press **Enter** key to set year, month and day.
- Press **Left** key to return main menu and exit SETTINGS.