

Quick Start Guide



- 1** Connections
- 2** Basic Setup
- 3** Enjoy

What's in the box?



Blu-ray Disc Player



Remote Control with Batteries (AA x 2)

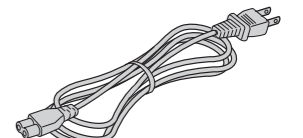

AC Cord

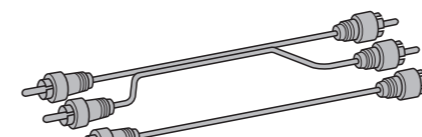

RCA Audio / Video Cables

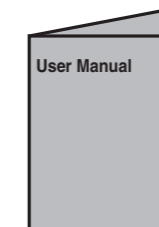

User Manual



Quick Start Guide

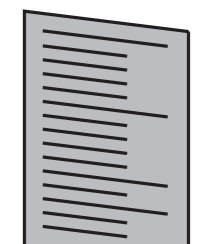

Registration Card

Troubleshooting

No reaction to the remote control.

- Connect the product to the power outlet.
- Point the remote control at the product.
- Insert the batteries correctly.
- Insert new batteries in the remote control.

Cannot play back a disc.

- Make sure that the product supports the disc.
- Make sure that the Blu-ray Disc player supports the region code of the DVD or BD. (BD: A: DVD: All or 1)
- For DVD+RW/+R or DVD-RW/-R, make sure that the disc is finalized.
- Clean the disc.

No video signal on the display device.

- Turn on the TV.
- Set the TV to the correct external input.
- Select the correct video resolution using **[OUTPUT]** on the front panel.
- Press and hold **[▶ (PLAY)]** on the front panel for 5 seconds to change the setting back to its default.

No 5.1-channel audio from the loudspeakers of the audio system.

- Does the disc contain 5.1-channel audio? The 5.1-channel audio is not available when the disc does not contain it.
- Does the audio system support 5.1-channel audio? The 5.1-channel audio is not available when the audio system does not contain it.
- In the settings menu, set "HDMI Audio" to "Off".

Need help?

User Manual

See the user manual that came with your Philips Blu-ray Disc Player.

Online

Go to www.philips.com/welcome.

Hotline

Call 1-888-PHILIPS (1-888-744-5477) for our operators.



2008 © PHILIPS CONSUMER ELECTRONICS
A Division of Philips Electronics North America Corp
P.O. Box 671539 Marietta, GA 30006 0026
All rights reserved.

Printed in China
E5E10UD
1VMN24456 *****



1 Connections

A Connection To The TV

ANALOG AUDIO CONNECTION

- 1 Take the supplied RCA audio cable.
- 2 Plug the red and white RCA audio cable into the AUDIO OUT (L/R) jacks of this unit.
- 3 Plug the other ends of the RCA audio cable into the audio input jacks of your TV.

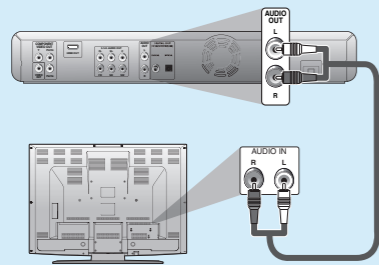

AND

VIDEO CONNECTION

Option 1 - Using Composite Video (standard quality)

- 1 Take the supplied RCA video cable.
- 2 Plug the yellow RCA video cable into the VIDEO OUT jack of this unit.
- 3 Plug the other end of the RCA video cable into the video input jack of your TV.

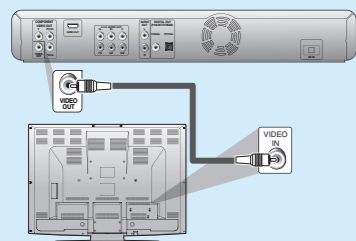

OR

Option 2 - Using Component Video (better quality)^{*1}

- 1 Take a green, blue, and red component video cable (not supplied).
- 2 Plug the component video cable into the COMPONENT VIDEO OUT jacks of this unit.
- 3 Plug the other ends of the component video cable into the component video input jacks of your TV.

COMPONENT VIDEO OUT jacks

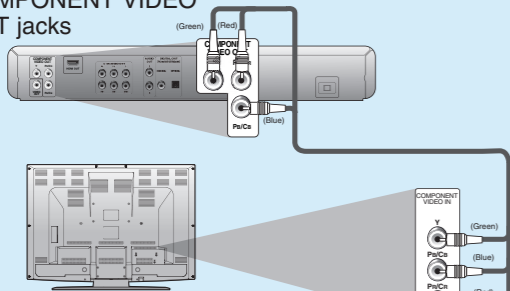

OR

Option 3 - Using HDMI (best quality)^{*1}

- 1 Take an HDMI cable or an HDMI-DVI cable (not supplied).
- 2 Plug one end of the HDMI cable or HDMI plug of HDMI-DVI cable into the HDMI OUT jack of this unit.
- 3 Plug the other end of the HDMI or HDMI-DVI cable into the HDMI or DVI input jack of your TV.

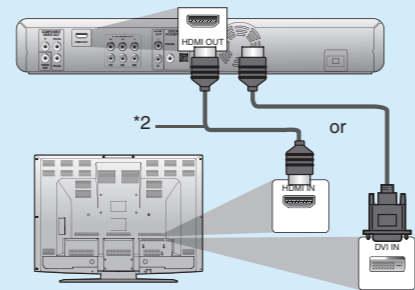

*1) This unit is compatible with the progressive scan system. The feature provides you with the higher quality pictures than traditional output system does. To utilize this feature, a component or an HDMI connection is required. Refer to the "HDMI Video Resolution" on page 35 or "Component Output" on page 31 in the user manual to set the resolution.

*2) This type of connection requires no analog audio connection.

Supplied cables used in these connection are as follows:

- RCA audio cable (L/R) x 1
- RCA video cable x 1

Please purchase the rest of the necessary cables at your local store.

CONNECTING THE AC CORD

After you made all necessary connections, connect the AC cord to the AC IN. Then connect the AC cord to the AC outlet.

Insert the plugs securely. Incomplete connections will result in the generation of noise.

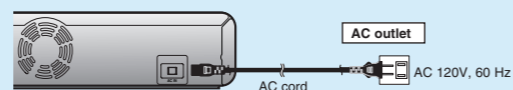

Supplied cables used in this connection are as follows:

- AC cord x 1

Note: Refer to the user manual for other possible connections and important safety instructions.

2 Basic Setup

A Finding The Viewing Channel On Your TV

- 1 After you have made all the necessary connections, press [**STANDBY-ON**] to turn on the unit.
- 2 Turn on your TV.
- 3 Press "2" on the TV's remote control, then press channel down button repeatedly until you see the PHILIPS splash screen.



This is the correct viewing channel (external input channel).

- For some TVs, there may be a button on the TV's remote control that accesses the external input channel. It may be labeled "SOURCE", "AV" or "SELECT". Refer to your TV's user manual for details.
- If a certain amount of time has past since you turned on the unit, you may see the home menu instead of the PHILIPS splash screen.

Home menu:

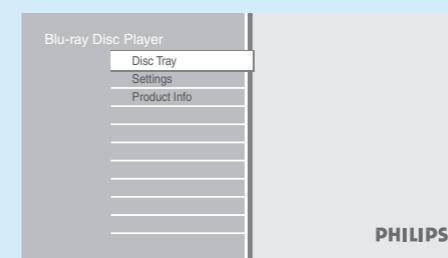

The BDP7200 is now ready for use.

3 Enjoy

A Start Disc Playback

- 1 Press [**OPEN/CLOSE**] to open the disc tray.
- 2 Place the disc on the disc tray with its label side facing up.

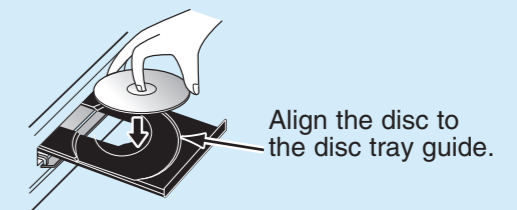

* Make sure the disc is compatible with this unit. (Refer to page 19 in the user manual for the list of compatible discs.)

- 3 Press [**OPEN/CLOSE**] to close the disc tray.

It may take a while to load the disc.

- 4 Playback may start automatically. If not, press [**PLAY**].

To pause playback:

Press [**PAUSE**].

To return to the normal playback:

Press [**PLAY**].

To stop playback:

Press [**STOP**].

To eject the disc:

Press [**OPEN/CLOSE**] to open the disc tray.

Remove the disc.

Press [**OPEN/CLOSE**] to close the disc tray.

