

# 3 Enjoy

## Start disc playback

- 1 Press **OPEN/CLOSE** to open the disc tray.

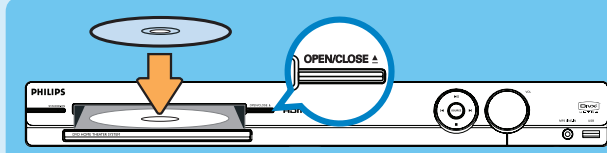

- 2 Place a disc with the disc label facing up.
- 3 Press **OPEN/CLOSE** to close the disc tray.
- 4 Playback starts automatically.
- 5 If the disc menu appears on the TV, use keys or the numeric keypad to select an option in the menu and press **OK** to start playback.
- 6 To enjoy the powerful surround sound from the speakers, press **SURROUND** on the remote control to turn on the multi-channel surround mode.
- 6 Press to stop playback.

**Note** When you press button, playback resumes from where it last stopped. To start playback from the beginning, you have to press .

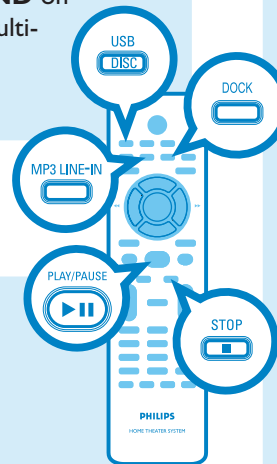

## Playback other supported devices

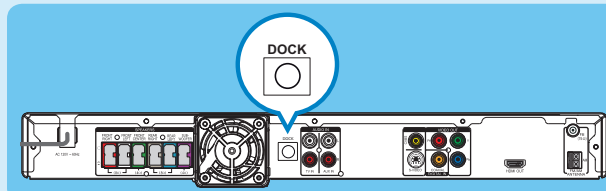

### Philips GoGear/Apple iPod

- 1 Connect the docking station to the **DOCK** jack.
- 2 Place the correct dock adaptor to the GoGear or iPod cradle before docking your GoGear or iPod on it.
- 3 Press **DOCK** to switch to 'DOCK' mode.
- 4 Press **PLAY** on your GoGear or iPod.

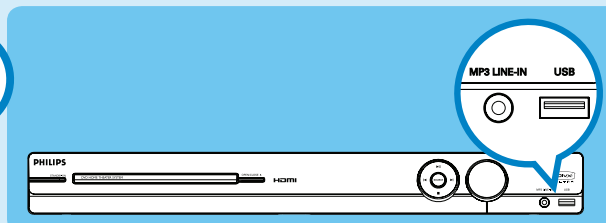

### USB device

- 1 Insert your USB device to the USB jack.
- 2 Press **DISC/USB** to switch to 'USB' mode.
- 3 Press to start playback.
- 4 To stop playback, press **DISC/USB** to switch to 'DISC' mode. You can unplug your USB device now.

### Other portable audio player

- 1 Use a MP3 LINE-IN cable (not supplied) to connect the headphone output jack on your portable audio player to MP3 LINE-IN jack.
- 2 Press **PLAY** on your portable audio player.
- 3 Press **MP3 LINE-IN** to listen to the playback.

## Need help?

### User Manual

See the user manual that came with your Philips DVD Home Theater System.

### Online

Go to [www.philips.com/welcome](http://www.philips.com/welcome)

### Hotline

Call 1-888-PHILIPS (1-888-744-5477) for our operators.



2007 © Philips Consumer Electronics  
A Division of Philips Electronics North America Corp  
P.O. Box 671539 Marietta, GA 30006 0026  
All rights reserved.  
Printed in China  
eng\_718-1

# Quick Start Guide



- 1 Connect
- 2 Set up
- 3 Enjoy

## What's in the box?



Main Unit



Remote Control and 2 batteries

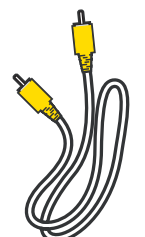

Composite video cable

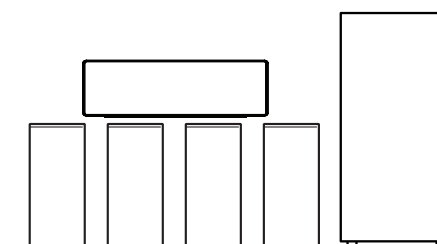

1 center, 2 front, 2 rear speakers and subwoofer



FM wire antenna

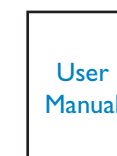

User Manual

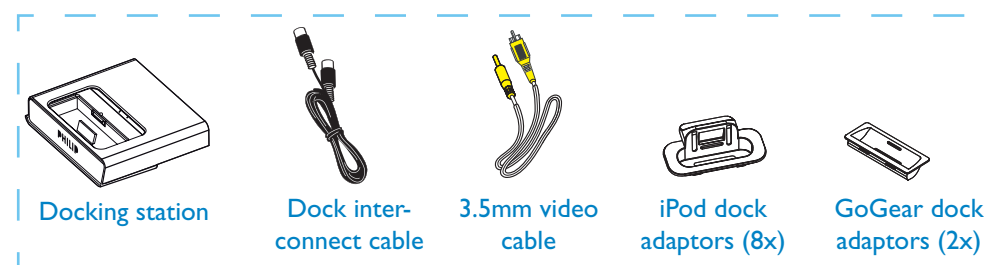

Docking station

Dock inter-connect cable

3.5mm video cable

iPod dock adaptors (8x)

GoGear dock adaptors (2x)



# 1 Connect

## A Placement

Proper speakers system placement is important to ensure optimum sound performance.

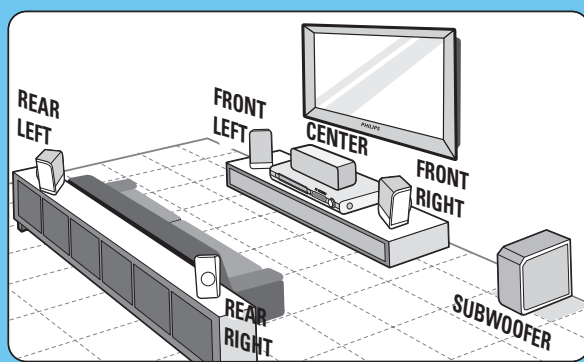

- 1 Place the center speaker above or close to the TV.
- 2 Place the subwoofer on the floor, at least one meter away from the TV.
- 3 Place the front speakers at equal distances from the TV.
- 4 Place the rear speakers at normal listening ear level.

## B Connect the main unit to TV

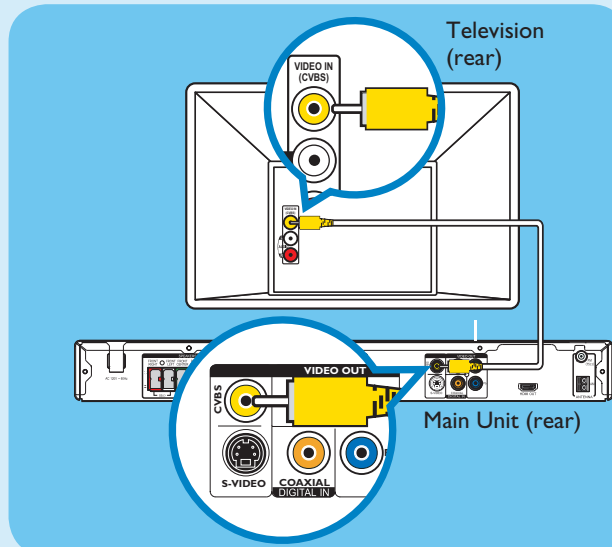

- Use a composite video cable (supplied) to connect the CVBS jack on the main unit to the VIDEO IN jack on your TV.

**Note** It is important to connect the main unit directly to your TV.

## C Connect the speakers and subwoofer

Connect the various colored plugs from the speakers and subwoofer to the same colored jacks at the rear of the main unit.

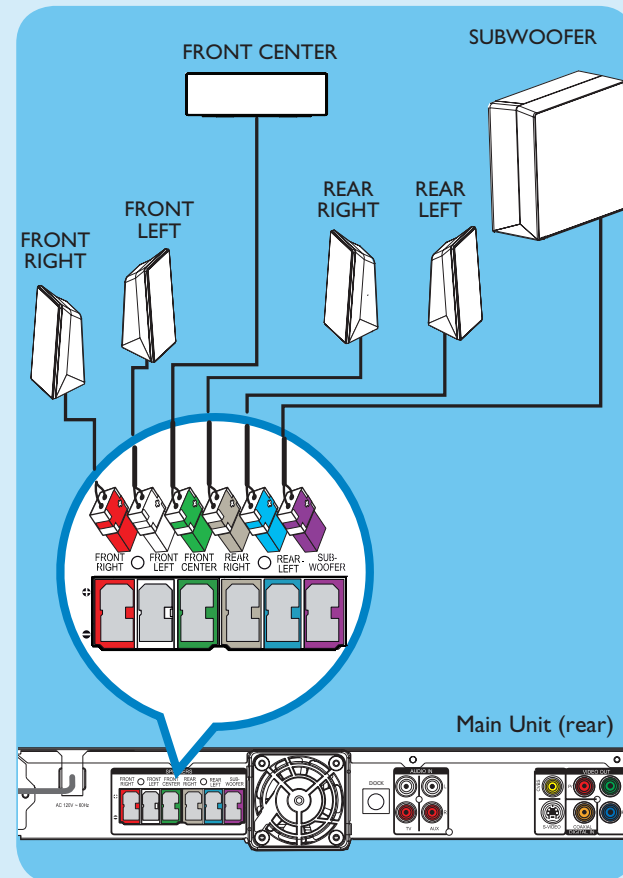

## D Connect the radio antennas and power cable

Keep the antennas away from the electronic devices to prevent unwanted interference.

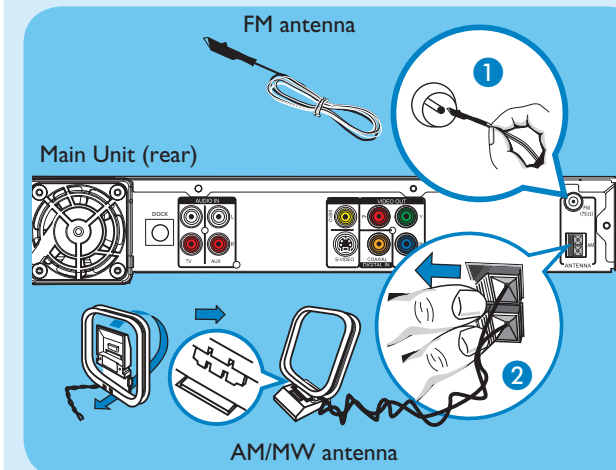

- 1 Connect the FM antenna to the inner pin of the FM 75 Ω jack. Extend the wire for optimum reception.
- 2 Unfold the AM/MW loop antenna (optional - not supplied) and fix the claw into the slot. Push the tabs and insert the wires into the AM/MW jacks.
- 3 Connect in the power cable from the main unit to the AC power outlet.

## E Connect audio output from TV (optional)

To hear the TV audio through this home theater system, use a red and white audio cables (not supplied) to connect the AUDIO IN-TV jacks on the main unit to the AUDIO OUT jacks on your TV.

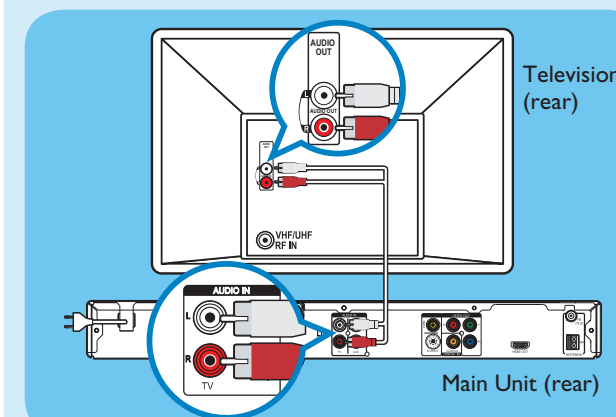

**Note** When watching the TV programs, you can press **TV** on the remote control to get the sound output from the speakers.

# 2 Set up

## A Finding the viewing channel

- 1 Press **⏻** (STANDBY ON) on the main unit to turn it on.
- 2 Turn on the TV. Use the TV's remote control to select the correct viewing channel.

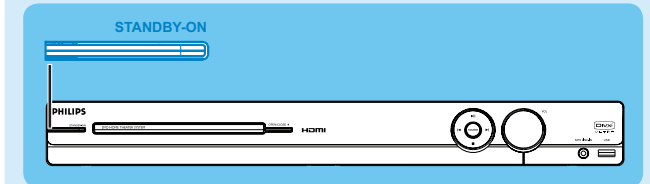

**Note** To search for the correct viewing channel, press the Channel Down button on the TV's remote control repeatedly (or AV, SELECT, **⏻** button) until you see the Video In channel. If you are using a RF modulator, set the TV to channel 3 or 4.

## B Select the display language on the screen

- 1 Press **SETUP**. The { General Setup Page } appears.

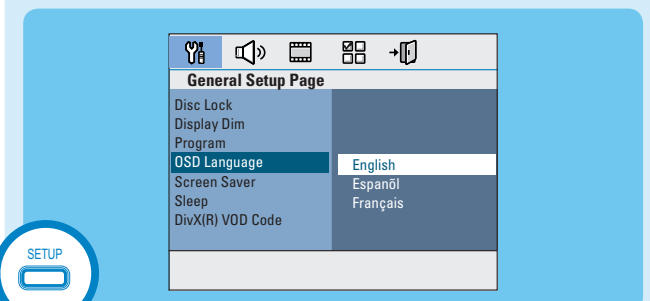

- 2 Press **▼** to select { OSD Language } and press **▶**.
- 3 Use **▼▲** keys to select a language option in the menu and press **OK** to confirm.
- 4 Press **SETUP** to exit.

**Note** The language set here is only for the menus that are shown on the TV while operating this Home Theater system, not for the DVD disc menu.

There are various setup options (Audio Setup, Video Setup, Preference Setup) available on this Home Theater System. Refer to the user manual for more information.