

3 Enjoy

Start disc playback

- 1 Press **▲** to open the disc tray.

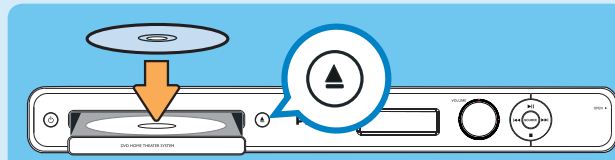

- 2 Place a disc with the disc label facing up.
- 3 Press **▲** to close the disc tray.
- 4 Playback starts automatically.
- 5 If the disc menu appears on the TV, use **◀▶▲▼** keys or the numeric keypad to select an option in the menu and press **OK** to start playback.
- 6 Press **■** to stop playback.

Note When you press **▶▶**, playback resumes from where it last stopped. To start playback from the beginning, you have to press **◀**.

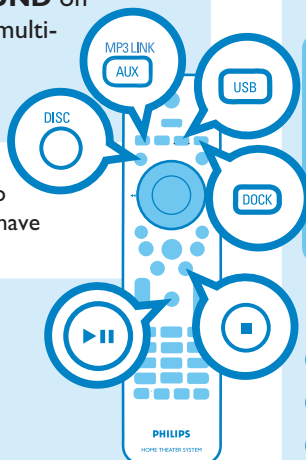

Playback other supported devices

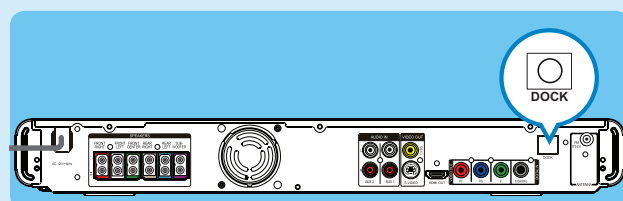

Apple iPod

- 1 Connect the docking station to the **DOCK** jack.
- 2 Dock your iPod in the docking station and adjust the support to fit it. Then turn on the iPod.
- 3 Press **DOCK** to switch to 'DOCK' mode.
- 4 Press **PLAY** on your iPod.

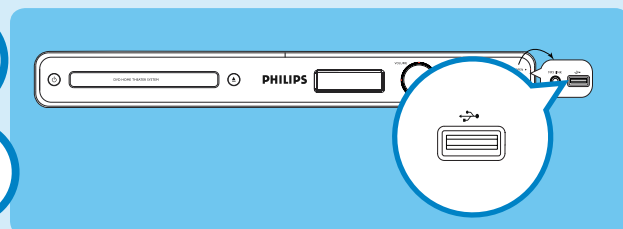

USB device

- 1 Connect your USB device to the **USB** jack.
- 2 Press **USB** to switch to 'USB' mode.
- 3 Press **▶▶** to start playback.
- 4 To stop playback, press **DISC** to switch to 'DISC' mode. You can unplug your USB device now.

Other portable audio player

- 1 Use a 3.5mm stereo audio cable (not supplied) to connect the headphone output jack on your portable audio player to MP3 LINK jack.
- 2 Press **PLAY** on your portable audio player.
- 3 Press **AUX (MP3 LINK)** repeatedly until 'MP3 LINK' is displayed to listen to the playback.

Register your product and get support at
www.philips.com/welcome

HTS3565D
HTS3566D



- 1 Connect
- 2 Set up
- 3 Enjoy

Quick Start Guide

What's in the box?

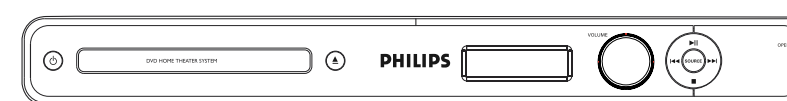

Main Unit

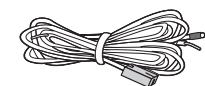

Speaker cables
(for tallboy speakers connection)



2 Screws
(for tallboy speakers connection)

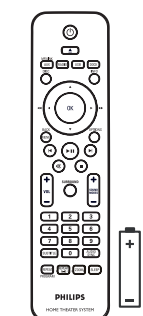

Remote Control
and 2 batteries

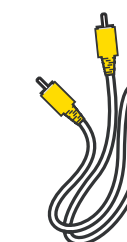

Composite
video cable

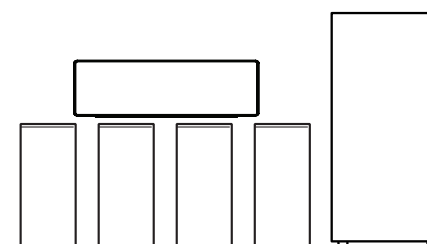

1 center, 2 front, 2 rear speakers
and subwoofer
(Tallboy rear speakers for HTS3566D model)

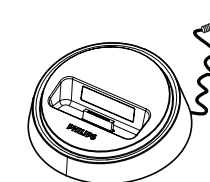

Docking station



User Manual



FM wire antenna

Need help?

User Manual

See the user manual that came with your Philips DVD Home Theater System.

Be responsible
Respect copyrights



2008 © Philips Consumer Electronics
A Division of Philips Electronics North America Corp
P.O. Box 671539 Marietta, GA 30006 0026
All rights reserved.
Printed in China
sgpjy_0813/37_03_eng

PHILIPS

1 Connect

A Placement

Proper speakers system placement is important to ensure optimum sound performance.

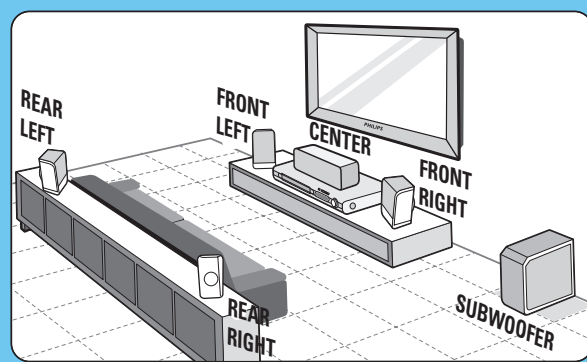

* Tallboy rear speakers for HTS3566D model.

- 1 Place the center speaker above or close to the TV.
- 2 Place the subwoofer on the floor, at least one meter away from the TV.
- 3 Place the front speakers at equal distances from the TV.
- 4 Place the rear speakers at normal listening ear level.

B Connect the main unit to TV

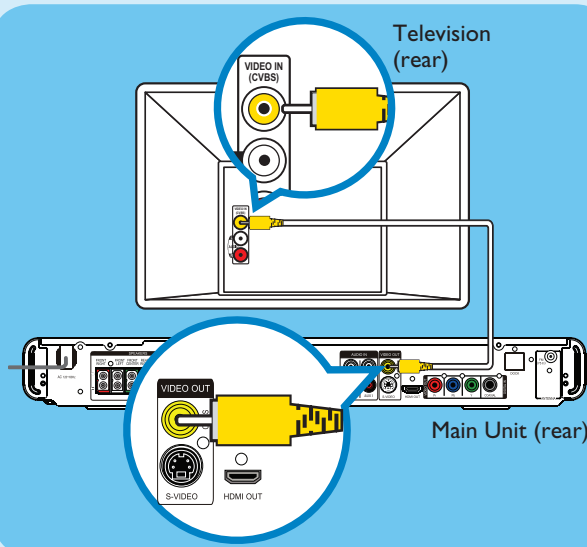

- Use the supplied composite video cable to connect the CVBS jack on the main unit to the VIDEO IN jack on your TV.

Note It is important to connect the main unit directly to your TV.

C Assemble the tallboy speakers (for HTS3566D only)

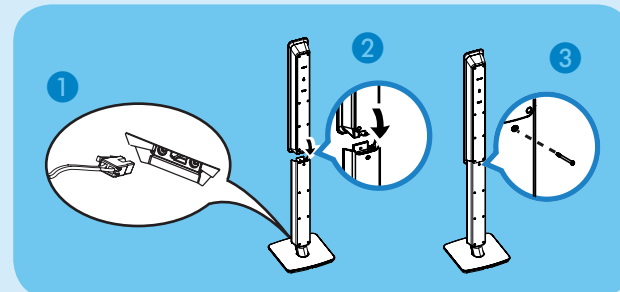

- 1 Connect the speaker cables to the matching colour sockets on the speakers (or speaker stands).
- 2 Place the stands upright and lock the speakers down into position.
- 3 Secure the position with screws (supplied).

D Connect the speakers and subwoofer

Connect the various colored cables from the speakers and subwoofer to the same colored jacks at the rear of the main unit.

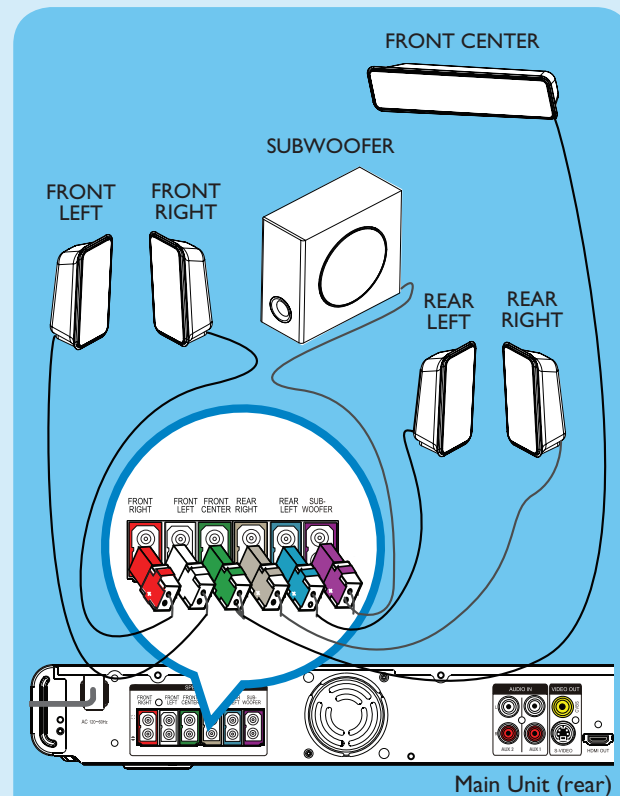

* Tallboy rear speakers for HTS3566D model.

E Connect the radio antenna and power cable

Keep the antenna away from the electronic devices to prevent unwanted interference.

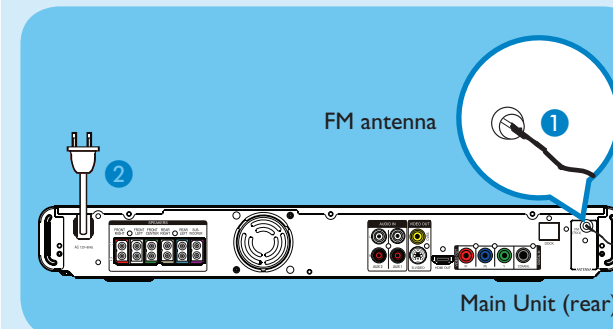

- 1 Connect the FM antenna (supplied) to the inner pin of the FM 75 Ω jack. (For some models, it has been connected in the factory.) Extend the wire for optimum reception.
- 2 Connect in the power cable from the main unit to the AC power outlet.

F Connect audio output from TV (optional)

To hear the TV audio through this unit, use a red and white audio cables (not supplied) to connect the AUDIO IN-AUX1 or AUDIO IN-AUX2 jacks on the main unit to the AUDIO OUT jacks on your TV.

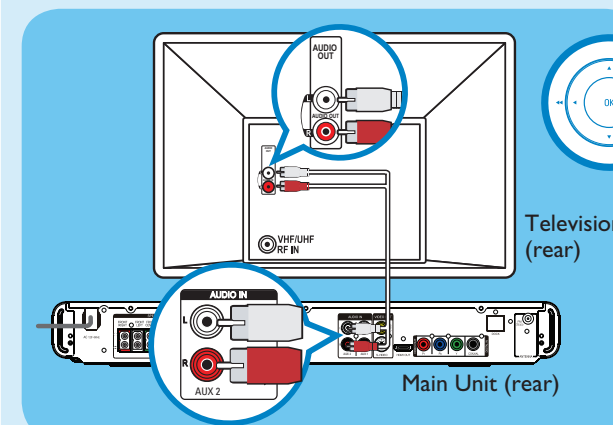

Note When watching the TV programs, you can press **AUX (MP3 LINK)** repeatedly on the remote control until 'AUX1' or 'AUX2' is displayed to get the sound output from the speakers.

2 Set up

A Finding the viewing channel

- 1 Press **⏻** on the main unit to turn it on.
- 2 Turn on the TV. Use the TV's remote control to select the correct viewing channel.

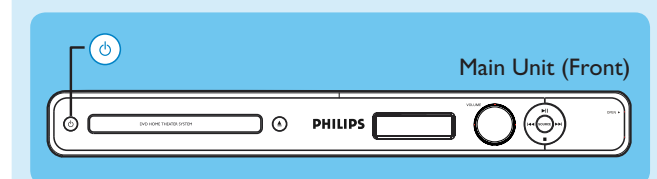

Note To search for the correct viewing channel, press the Channel Down button on the TV's remote control repeatedly (or AV, SELECT, **⏻** button) until you see the Video In channel. If you are using a RF modulator, set the TV to channel 3 or 4.

B Select the display language on the screen

- 1 Press **OPTIONS**. The { **General Setup** } appears.
- 2 Press **▶**.

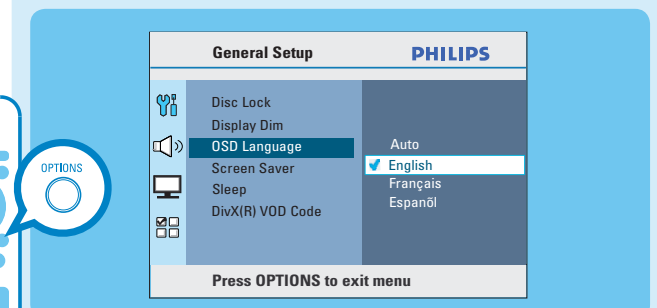

- 3 Use **▲▼** keys to select { **OSD Language** } in the menu, then press **▶**.
- 4 Use **▲▼** keys to select a language and press **OK** to confirm.
- 5 Press **OPTIONS** to exit.

Note The language set here is only for the menus that are shown on the TV while operating this Home Theater system, not for the DVD disc menu.

There are various setup options (Audio Setup, Video Setup, Preferences) available on this Home Theater System. Refer to the user manual for more information.